

PERGOLA POLY-TOP HORIZON III

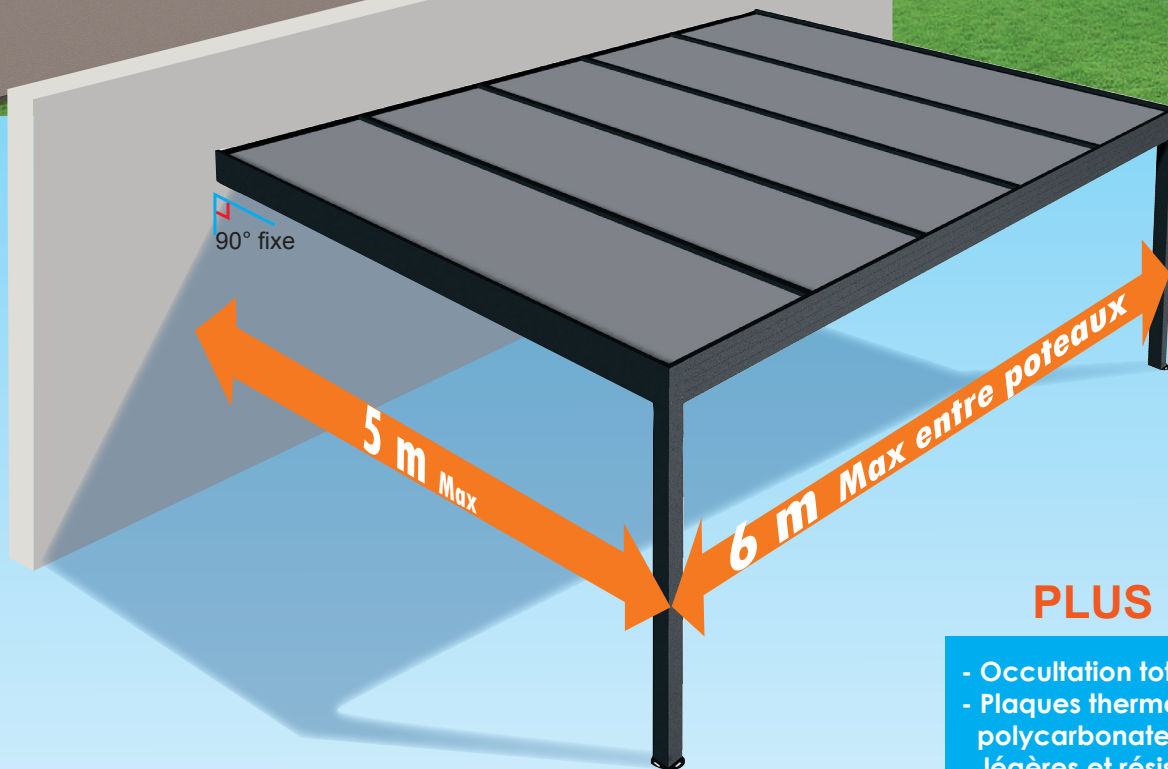

PRODUCT ADVANTAGES:

- Total and constant coverage
- 32mm Thermotop or Polycarbonate boards, lightweight and durable
- Easy assembly with clip-on system
- Board width up to 1.20m
- Multi-purpose coverage: driveway, garden, terrace
- Water drainage thanks to its posts
- Option to move posts up to 50cm
- 115 x 115 Post

PLUS PRODUIT :

- Occultation totale et constante
- Plaques thermotop ou de polycarbonate de 32mm légères et résistantes
- Assemblage facile avec système à clipper
- Largeur plaque jusqu'à 1,20 mètre
- Abris multi-usages : abris de voiture, terrasse et jardin
- Evacuation de l'eau grâce aux poutres
- Pieds déportés jusqu'à 50cm
- Poteaux de 115 x 115

 **MITJAVILA**

France : professionnels@mitjavila.com
Export : export-fr@mitjavila.com

POLY-TOP HORIZON III

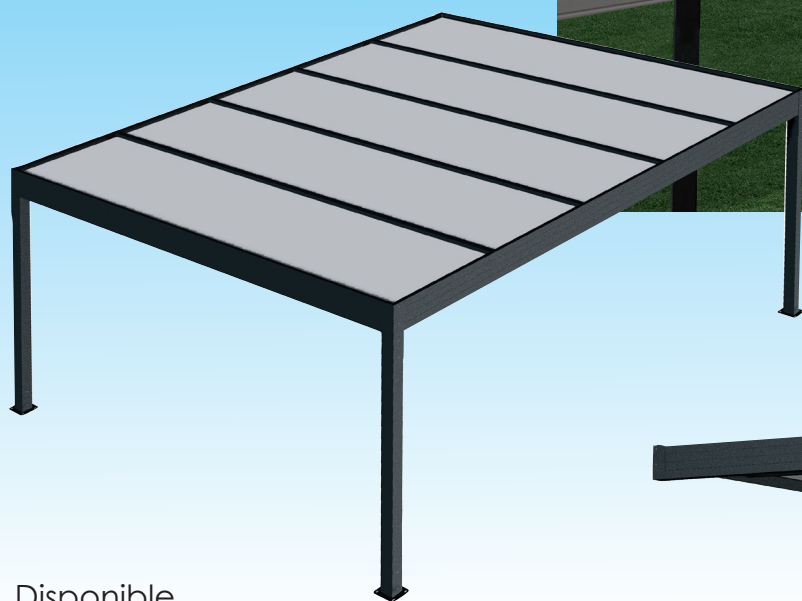
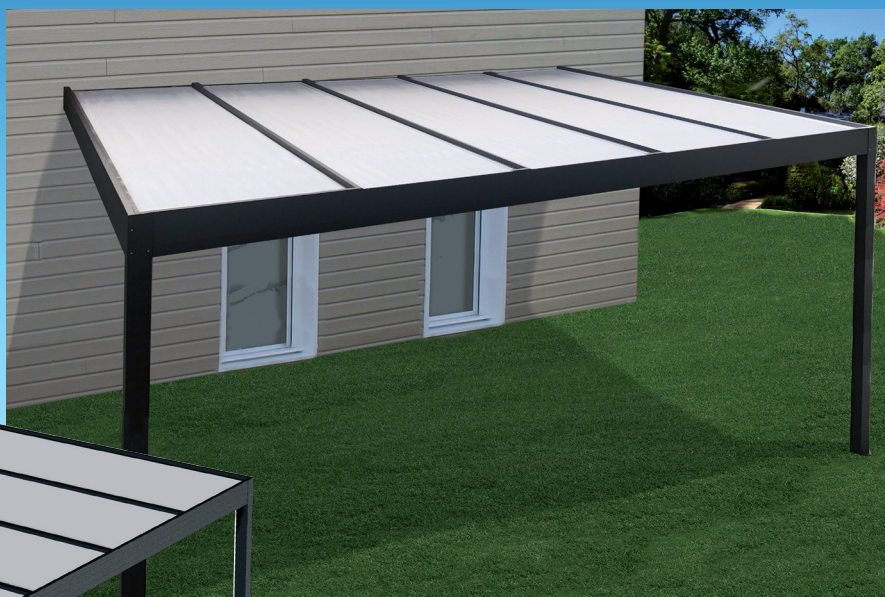

Disponible
en version îlot (4 pieds)
Free standing model
available (4 posts)

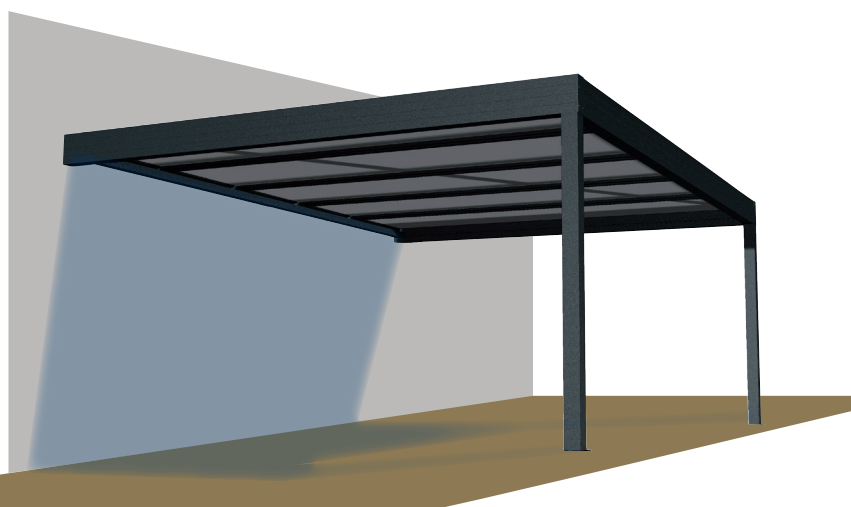

DIMENSIONS MAXI D'UTILISATION

Largeur par plaque : 1,20 mètre **Maxi**
Largeur entre les poteaux : 6,00 mètres
Avancée maxi : 5,00 mètres
Hauteur des poteaux : 2,50 mètres
Inclinaison fixe 0°
Pente des panneaux 5 cm

MAX DIMENSIONS:



Board width: 1.20 meters
Width between posts: 6.00 meters
Maximum projection: 5.00 meters
Post height: 2.50 meters
Fixed tilt: 0°
Slope of the panels 5 cm

INFORMATION TECHNIQUE / TECHNICAL INFORMATION

La nouvelle pergola POLY-TOP Horizon III est compatible avec tous les panneaux d'épaisseur 32mm, plaques de polycarbonate ou plaques de thermotop, afin d'ajuster au mieux l'ensoleillement de votre terrasse en fonction de vos besoins.

New POLY-TOP Horizon III Pergola is compatible with all 32mm thick boards, either Thermotopor Polycarbonate, for a better adjustment of the sunlight on your terrace according to your needs.

Panneaux (Thermotop) disponibles en :
Thermotop boards are available in:

-  - blanc & blanc (sur les 2 faces)
- White / White (Two sides)
-  - Anthracite & blanc (à l'intérieur)
- Anthracite and White (Inside)



Panneaux Thermotop
Thermotop boards



Attention ! les plaques polycarbonate sont susceptibles de noircir à chaque extrémité du fait de leur structure.
Warning ! polycarbonate sheets are likely to darken at each end because of their structure.

Panneaux polycarbonate
Polycarbonate boards

Clipper les profils de verrouillage des plaques. Easy board clip-on system

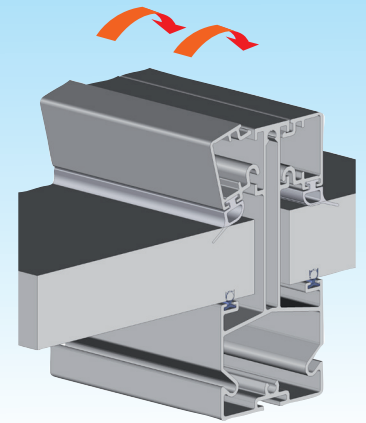
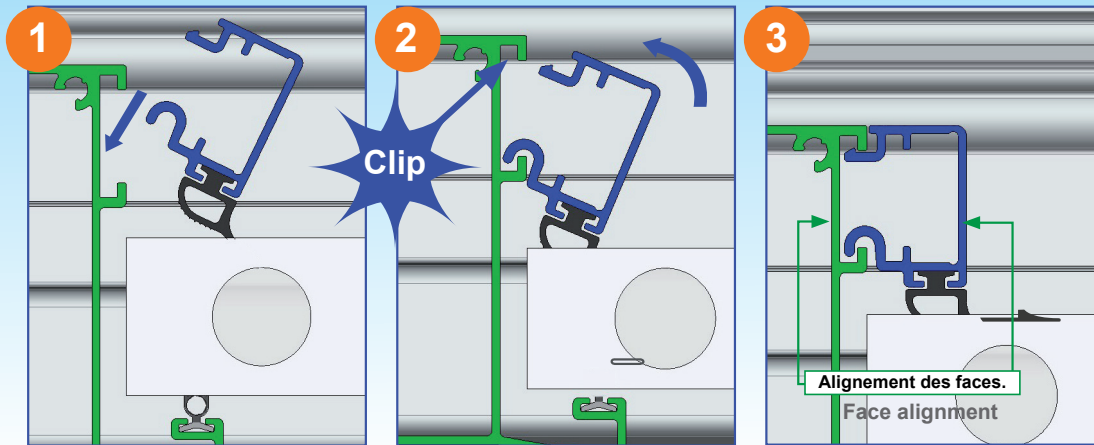

Evacuation de l'eau (drainage) Water drainage

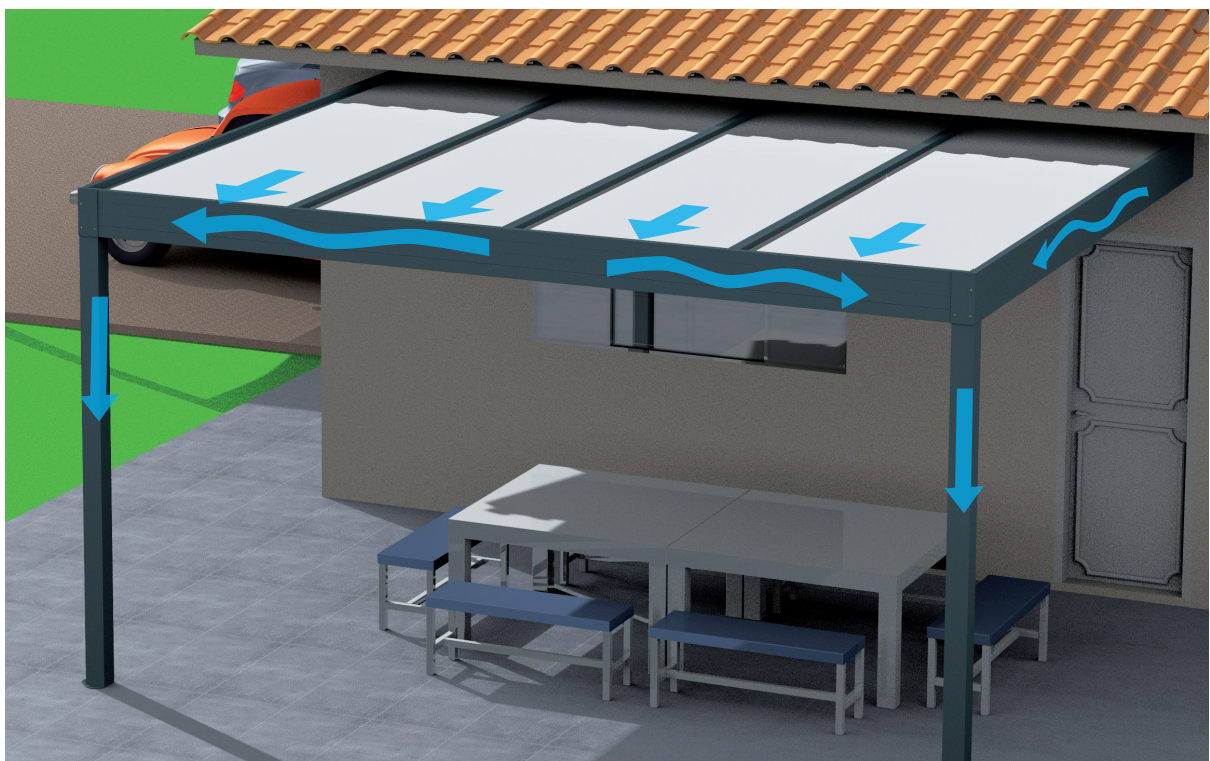

OPTIONS - ACCESSOIRES



Finition standard de la structure Standard frame finishing:

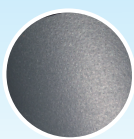

RAL 7016 ANTHRACITE
Laquage téflonné
RAL 7016 Textured powder
coat(anthracite)

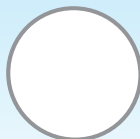

RAL 9010 blanc
Laquage brillant
RAL9010 - Glossy white
powder coat

Option éclairage LED Led lighting option:

- Nombre de ruban LED modulable (1 bandeau, 3 côtés au total)
- Commande à télécommande centralisée des LED
- Adjustable LED string (1 strip, 3 sidestotal)
- Operated by centralised remote control



Habillage latéral Side coverage



Habillage avec stores
screen coulissants
Side coverage with sliding
screens

Fixation au sol Floor fixation



Support de fixation au sol **ST4502**
Floor fixation support: **ST4502**



Support de fixation au sol **ST45**
Floor fixation support: **ST45**

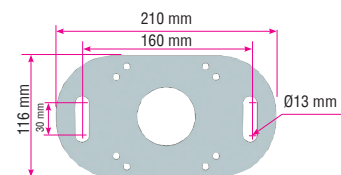
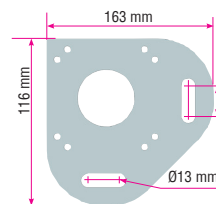

MITJAVILA

D900 - Km 7 - B.P.99
66602 RIVESALTES Cedex France
Tél +33 (0)4.68.38.20.00
Fax +33 (0)4.68.38.20.32
mailing@mitjavila.com
www.mitjavila.com